

# Installation Instructions

## Wireless Motion Sensor LED Ceiling Light

### MB980

**Thank you** for purchasing the Mr. Beams™ Ceiling Light. We are committed to eliminating darkness using the latest in Light-Emitting Diodes (LEDs). LEDs are the most efficient and durable light sources available. We are certain that your light will contribute to a safer environment and provide light where you need it at a very reasonable cost.

#### What is included per light:

- Wireless LED Ceiling Light
- 2 Screws & 2 Anchors
- Mounting Bracket

#### What you need to install:

- 4 C-Cell Alkaline Batteries
- Screwdriver

#### Ceiling Light Features:

**Motion/Light Sensor:** The Ceiling Light instantly turns on when it detects motion from up to 20 feet away. The light sensor conserves battery life by preventing the light from activating in daylight.

**Auto Shut-off:** Light shuts off automatically after 30 seconds if no motion is detected.

**Bright LED:** 100 Lumens covers up to 260 sq ft.

**Durable, Weather Resistant:** Tight seals and UV resistant material allow the Mr. Beams Ceiling Light to work in all weather conditions.

#### Tips:

- Use only new alkaline C-Cell batteries with 1.5V rating.
- Do not mix old and new batteries. If batteries are not new, it may cause the light to malfunction.
- Install batteries with polarity in correct position.
- Light may activate when batteries are inserted. Simply take light into a dark room. Allow batteries to settle, then test activation.
- **If your light will not turn off, it means that it is time to replace the batteries.**

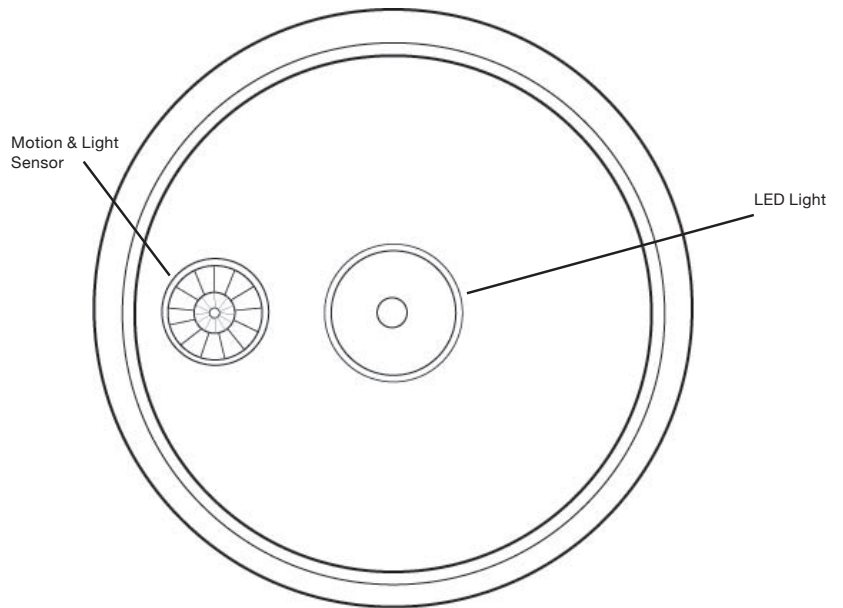

**NOTE: Light sensor only allows light to activate in darkness. We recommend you test in a dark room or closet.**

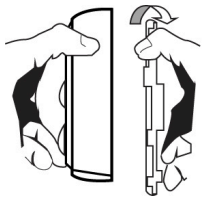

1. Remove mounting bracket from back of Ceiling Light. . Remove back plate of Ceiling Light by removing thumb screw.

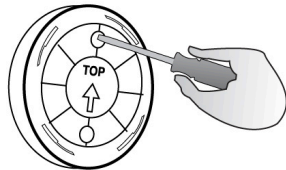

2. Insert 4 fresh C batteries.

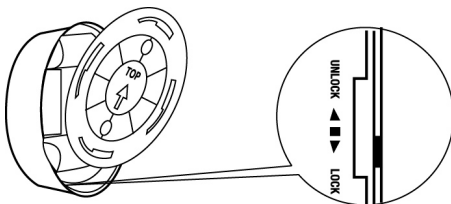
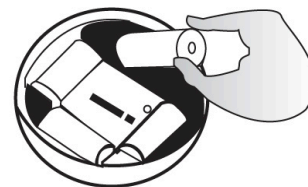
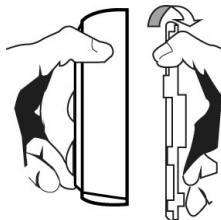

3. To close, align tab with notch. Rotate back plate clockwise. Insert thumb screw and tighten.

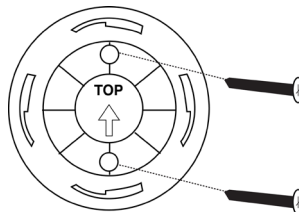

4. Determine the mounting location for the Ceiling Light. If mounting to a wall, position so word "TOP" is at highest point. The side with the word "TOP" should always face you. Drive two screws (included) through holes of mounting bracket to secure.

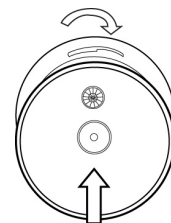

5. Position motion sensor lens towards the area of expected motion. Align tabs with grooves and twist Ceiling Light clockwise until it stops. Make sure light is secure.

\* Visit our website to view installation video.

\* 1 year limited warranty. See enclosed card for details.

**MR BEAMS™**  
Surprisingly Bright Light Anywhere  
www.mrbeams.com



32333 Aurora Rd. Suite 100 Solon, OH 44139  
877.298.9082